

ATLANTIC GENERAL HOSPITAL MEDICAL OFFICE BUILDING

Warehaus Project #2017.0063.00
Date: June 19, 2017

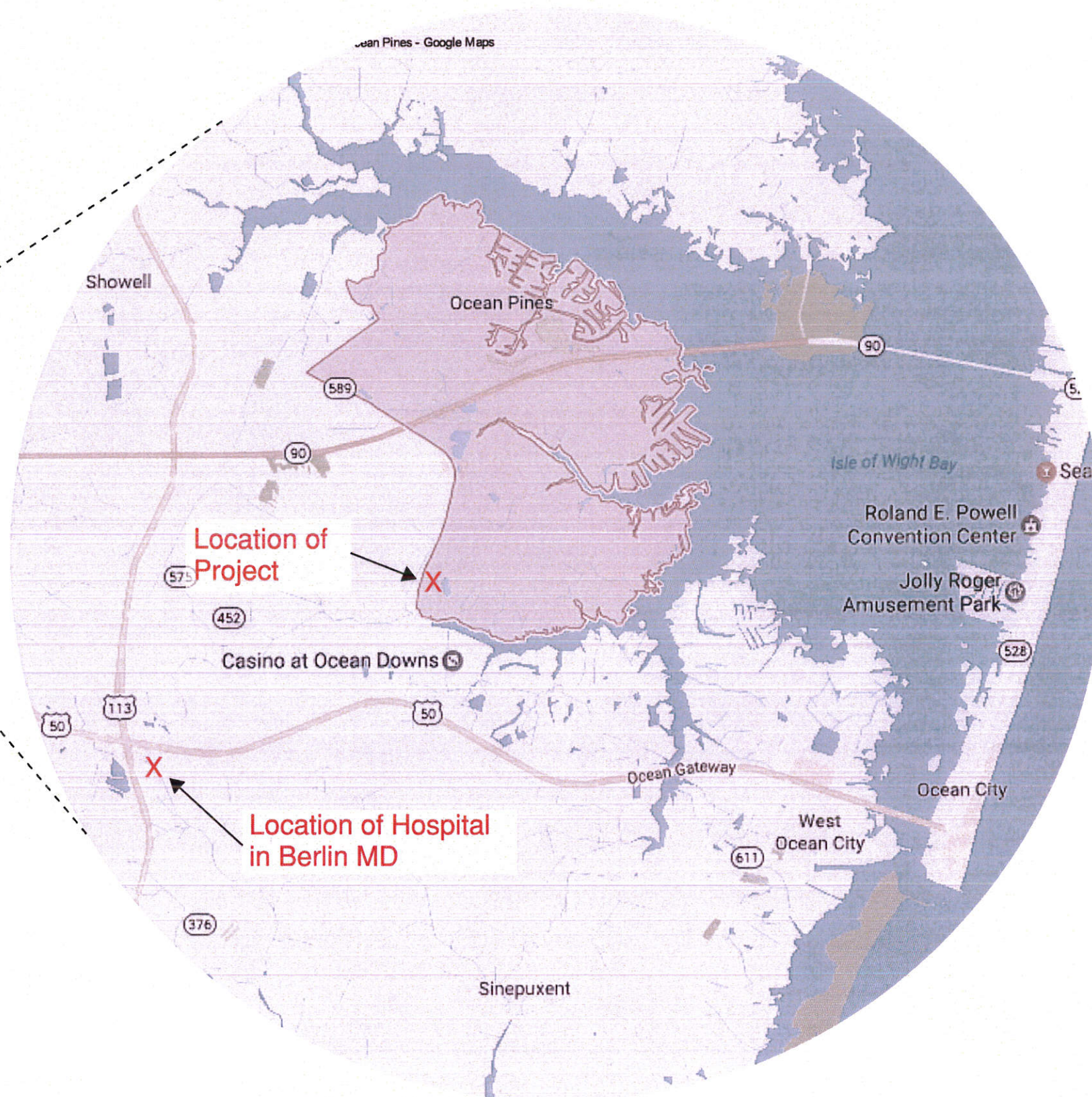
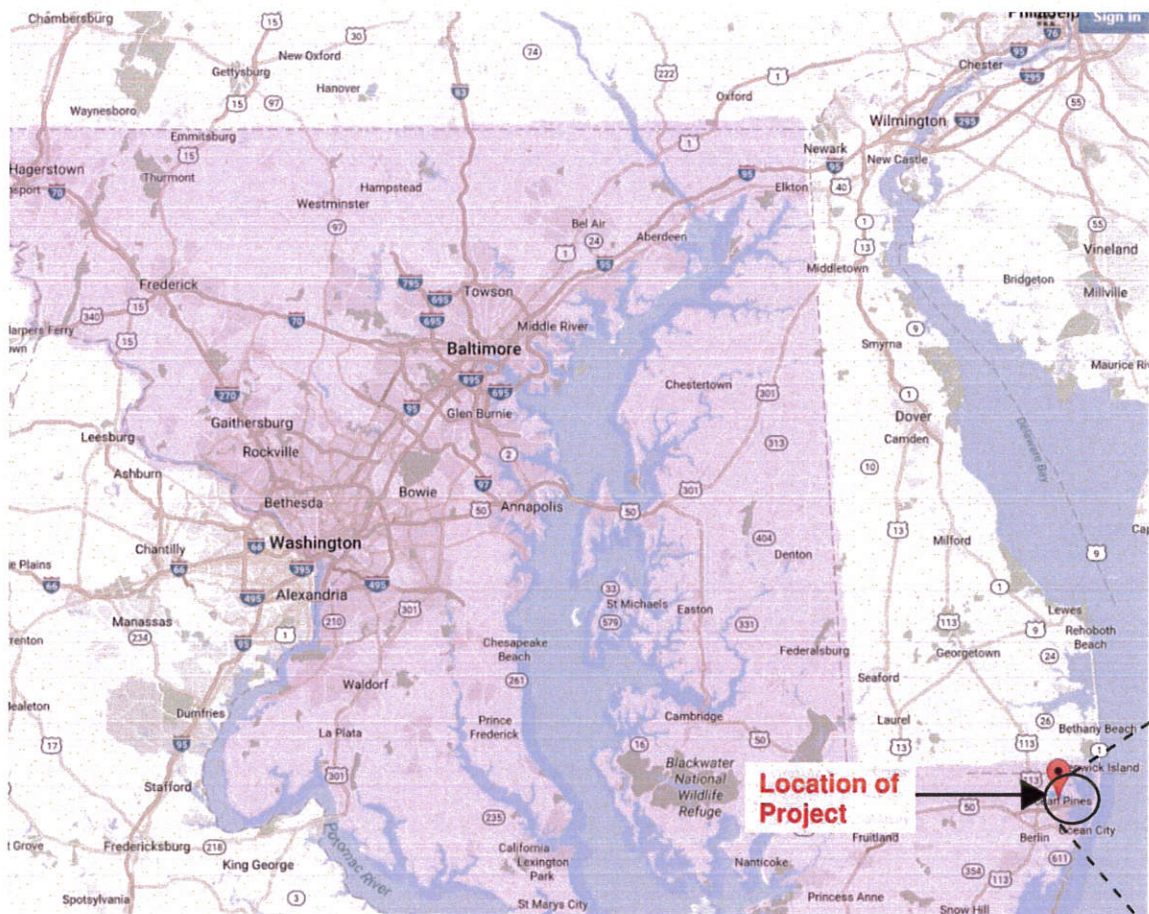

06-19-2017

Atlantic General Hospital - Medical Office Building

Site and Context Maps

WARE
HAUS

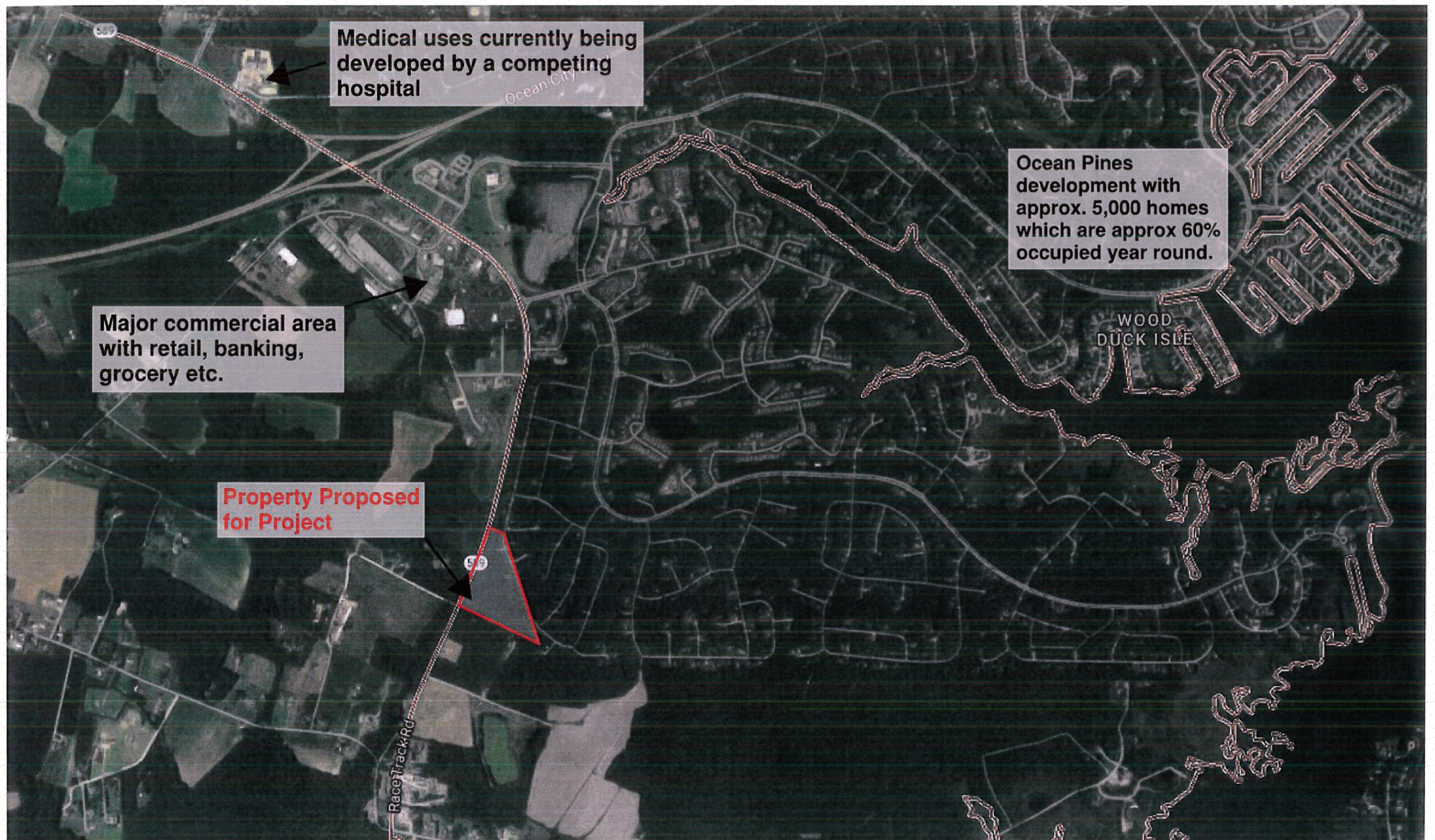

06-19-2017

Site and Context Maps

Atlantic General Hospital - Medical Office Building

WARE
HAUS

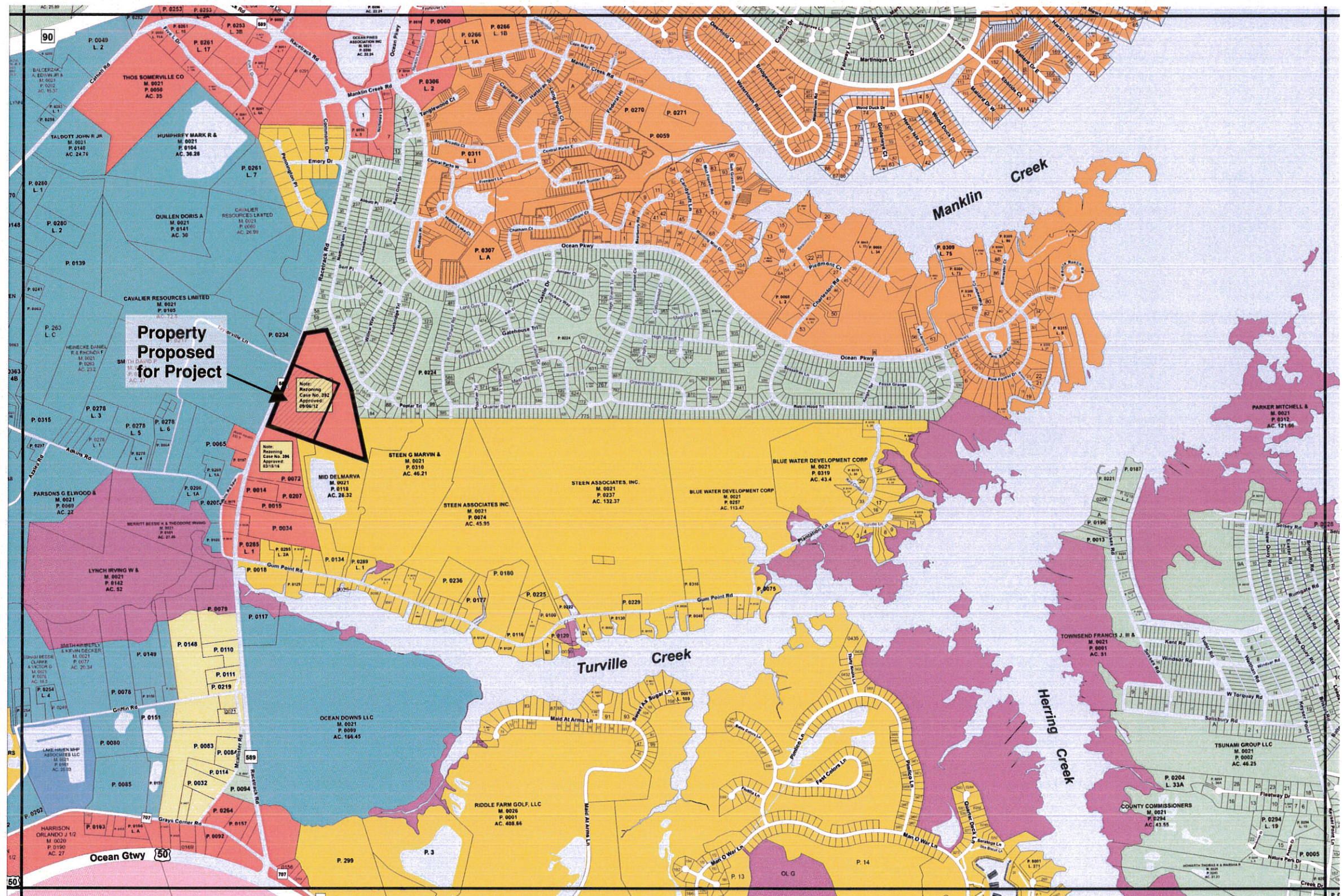

0 300 600 1,200 Feet

Official Zoning Map

Map prepared by Worcester County Department of Development Review and Permitting, November 3, 2009.
Source: Worcester County Commissioners; UPDATED: Resolution No. 12-01 and 16-01.

A1	RP	R2	I1	C1	V1
A2	E1	R3	I2	C2	MUN
CA	R1	R4	CM	C3	

Tax Map 21

06-19-2017

Atlantic General Hospital - Medical Office Building

Site and Context Maps

WARE
HAUS

BUILDING SUMMARY FUNCTION	March 31, 2017 PRESCRIBED	April 18, 2017 PROPOSED
URGENT CARE	5,000	10,000
PRIMARY CARE	8,000	8,000
DIABETES	4,000	6,000
PULMONOLOGY	4,000	5,300
NEUROLOGY	3,500	5,000
GASTROENTEROLOGY	3,500	5,000
AMBULATORY SURGERY CENTER	5,000	11,000
ORTHOPEDICS	15,000	15,000
PLASTIC SURGERY	4,000	5,000
CARDIOLOGY	3,000	5,000
USEABLE AREA TOTALS	55,000	75,300
COMMON AREAS	12,264	12,264
USEABLE + COMMON AREAS	67,264	87,564
CIRCULATION FACTOR	1.10	1.10
TOTAL GROSS BUILDING AREA	73,990	90,000-111,000

URGENT CARE					
Space	Metric	NSF	Qty.	Subtot	Notes
Waiting Room		300	1	300	
Reception		360	1	360	
Alcove, Copier		40	1	40	
Consult Room		120	1	120	
Security Station?		-	-	-	
Toilet		-	-	-	
Vending?		-	-	-	
Alcove, Water Fountain?		20	1	20	
Alcove, Wheel Chair		60	1	60	
Patient Room, Triage		120	1	120	
Exam Room		120	2	240	
Exam Room, Bariatric		225	1	225	
Exam/Treatment Room		140	2	280	
Procedure Room		180	1	180	
Patient Toilet		60	2	120	
Sub-waiting, Imaging		80	1	80	
Imaging dressing		80	1	80	
Radiology Procedure Rm.		400	1	400	
Radiology Alcove		40	1	40	
Team work room		120	1	120	
Medication Room		80	1	80	
Laboratory		120	1	120	
Clean Utility		120	1	120	
Soiled Utility		80	1	80	
Alcove, clean linen		60	1	60	
Alcove, wheel chair		60	1	60	
Equipment storage		120	1	120	
Janitorial		60	1	60	
Office, Director		100	1	100	
Office, Nurse Mgr.		100	1	100	
Staff Lounge		120	1	120	
staff locker room		120	1	120	
Staff toilet		-	-	-	
		-	-	-	
		-	-	-	
		-	-	-	
		-	-	-	
		-	-	-	
Total Net Area				3,925	
Grossing Factor				1.40	
Gross Area				5,495	
Proposed Area				10,000	

06-19-2017

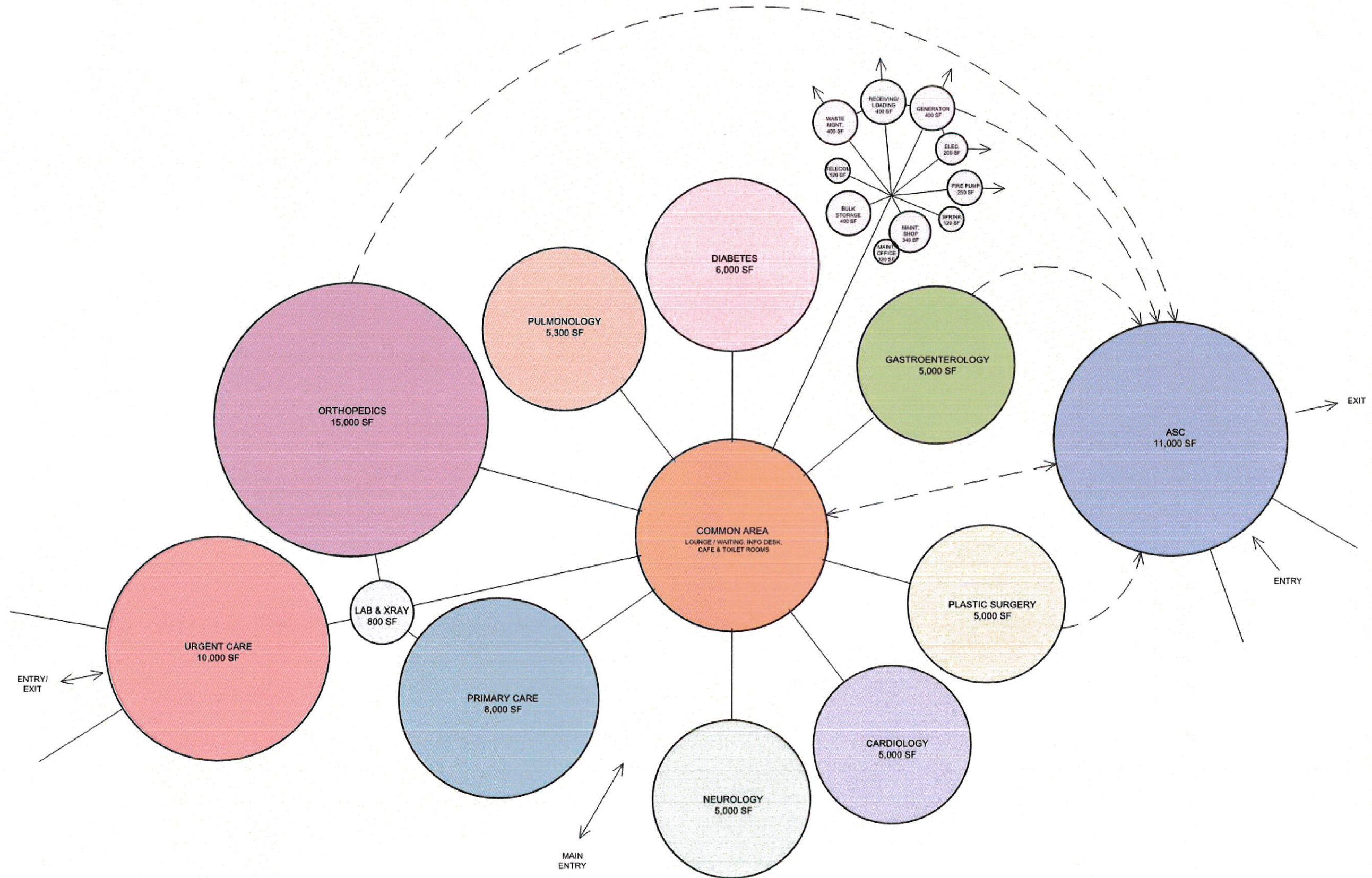

06-19-2017

CONCENTRIC

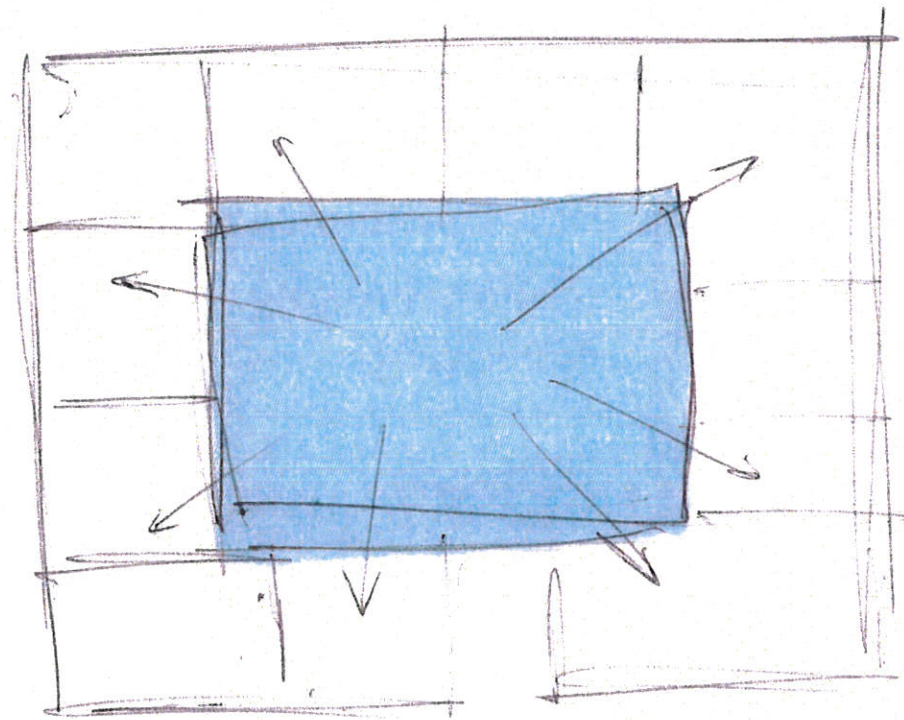

VILLAGE

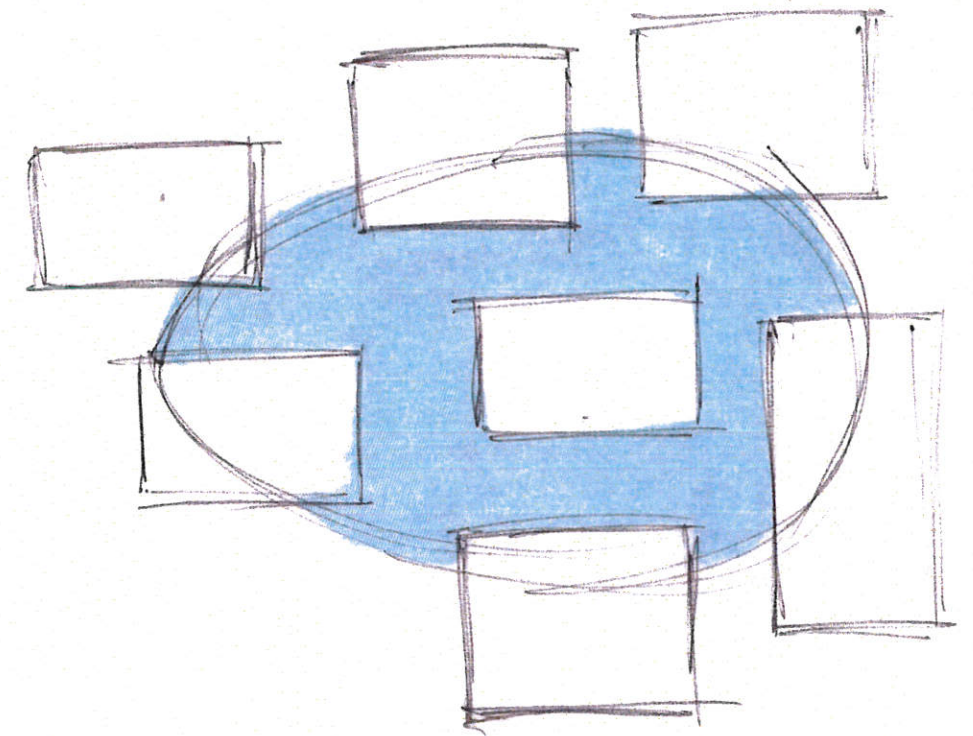

LINEAR

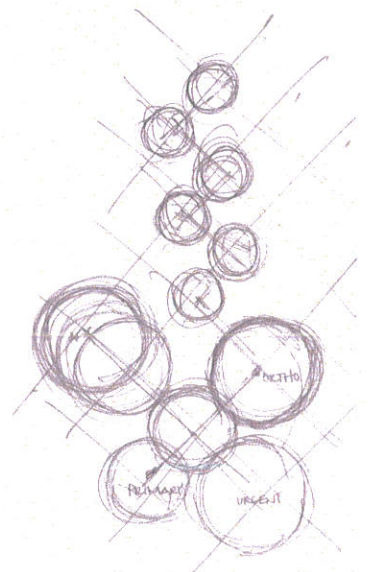
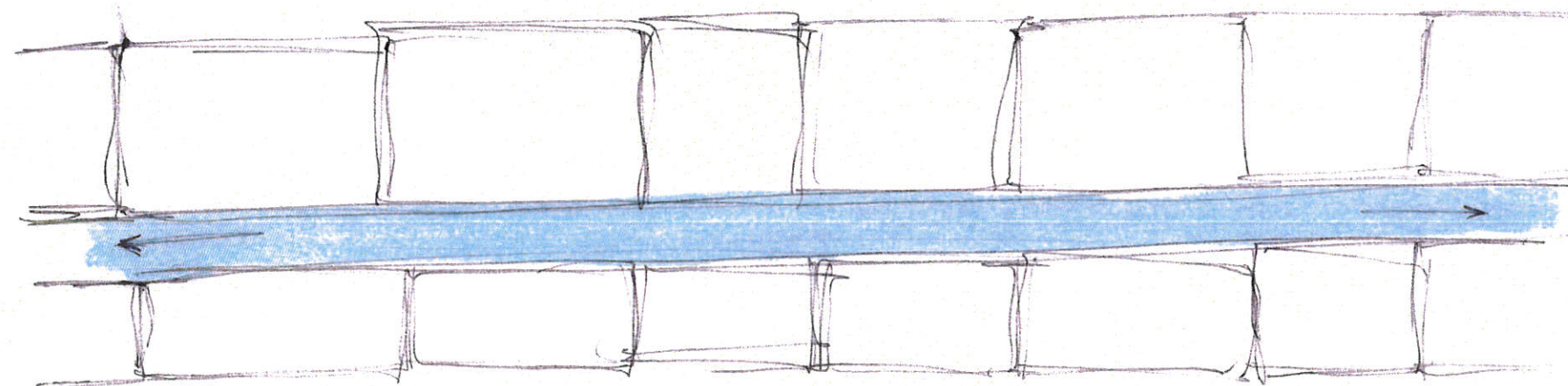
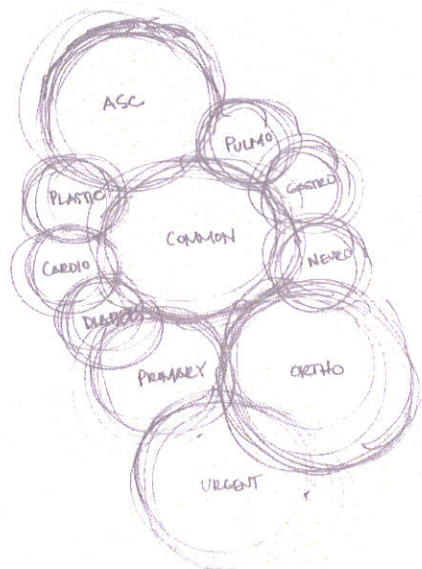

06-19-2017

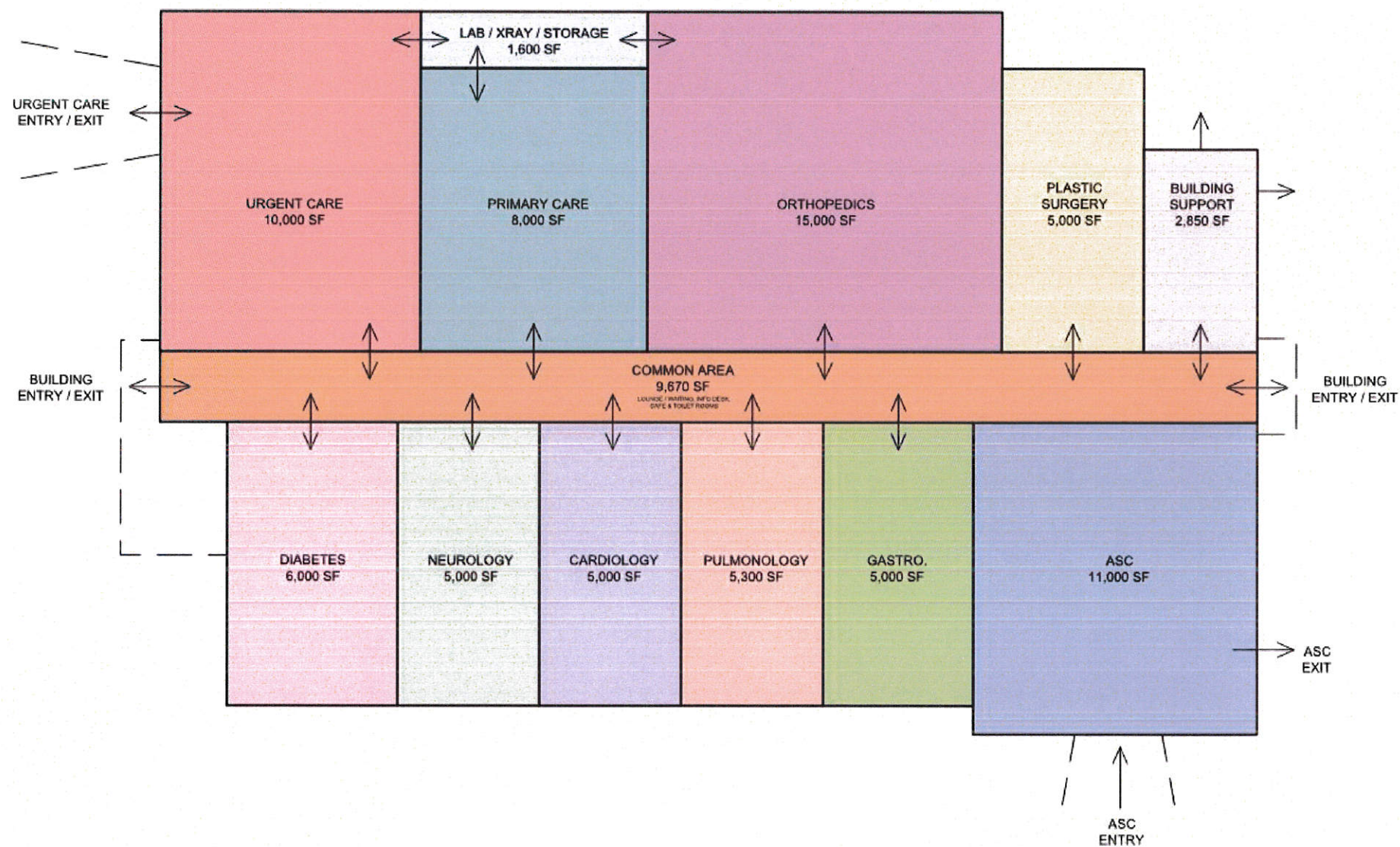
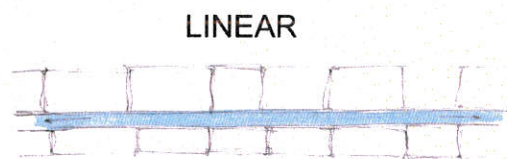

GROSS BUILDING AREA: 90,500 SF
453 PARKING SPACES @ 1 SPACE PER 200 SF



06-19-2017

CONCENTRIC

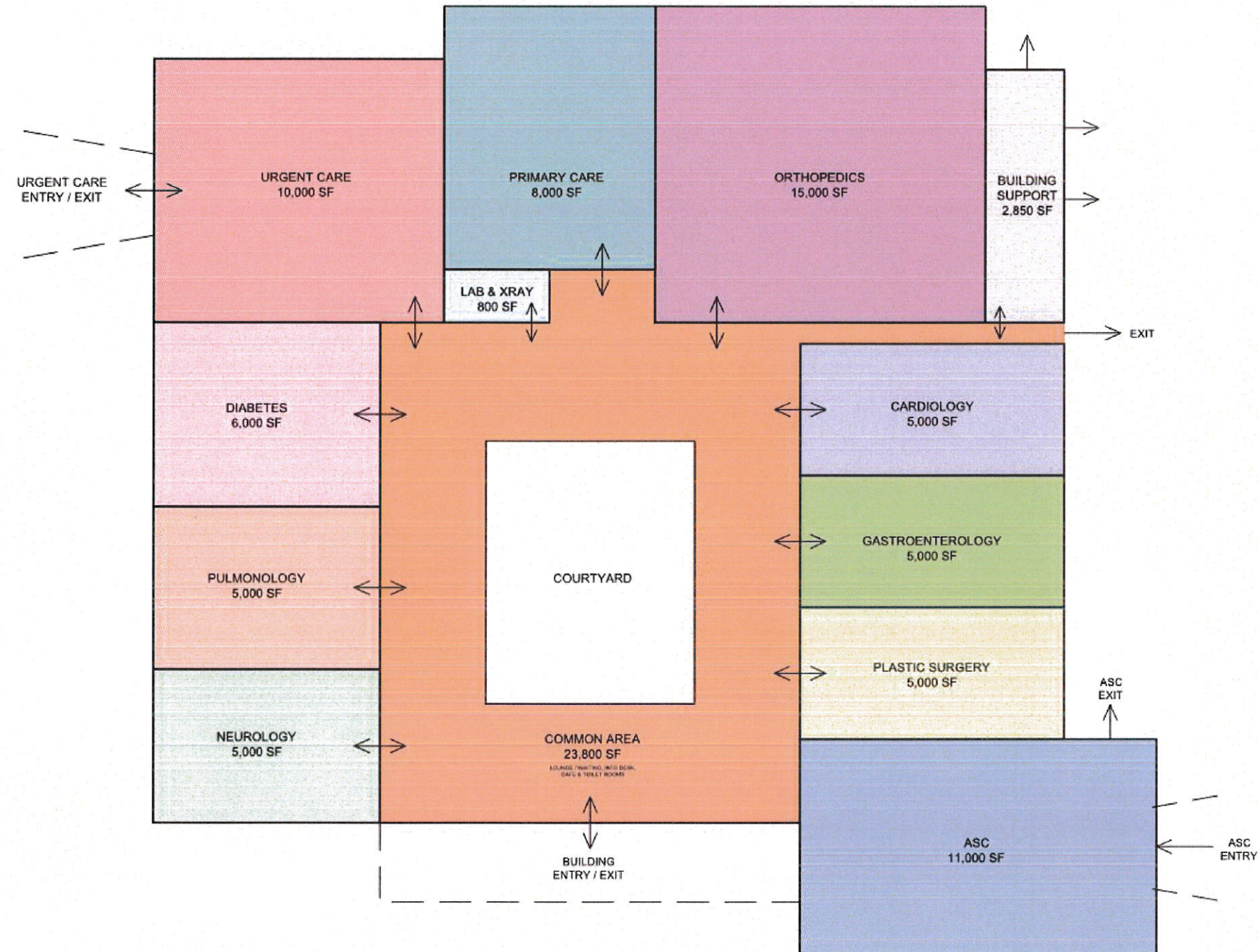
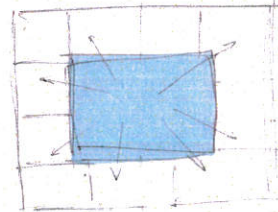

GROSS BUILDING AREA: 111,800 SF
559 PARKING SPACES @ 1 SPACE PER 200 SF

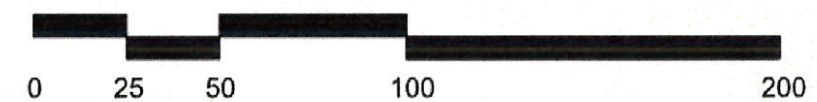

06-19-2017

CONCENTRIC

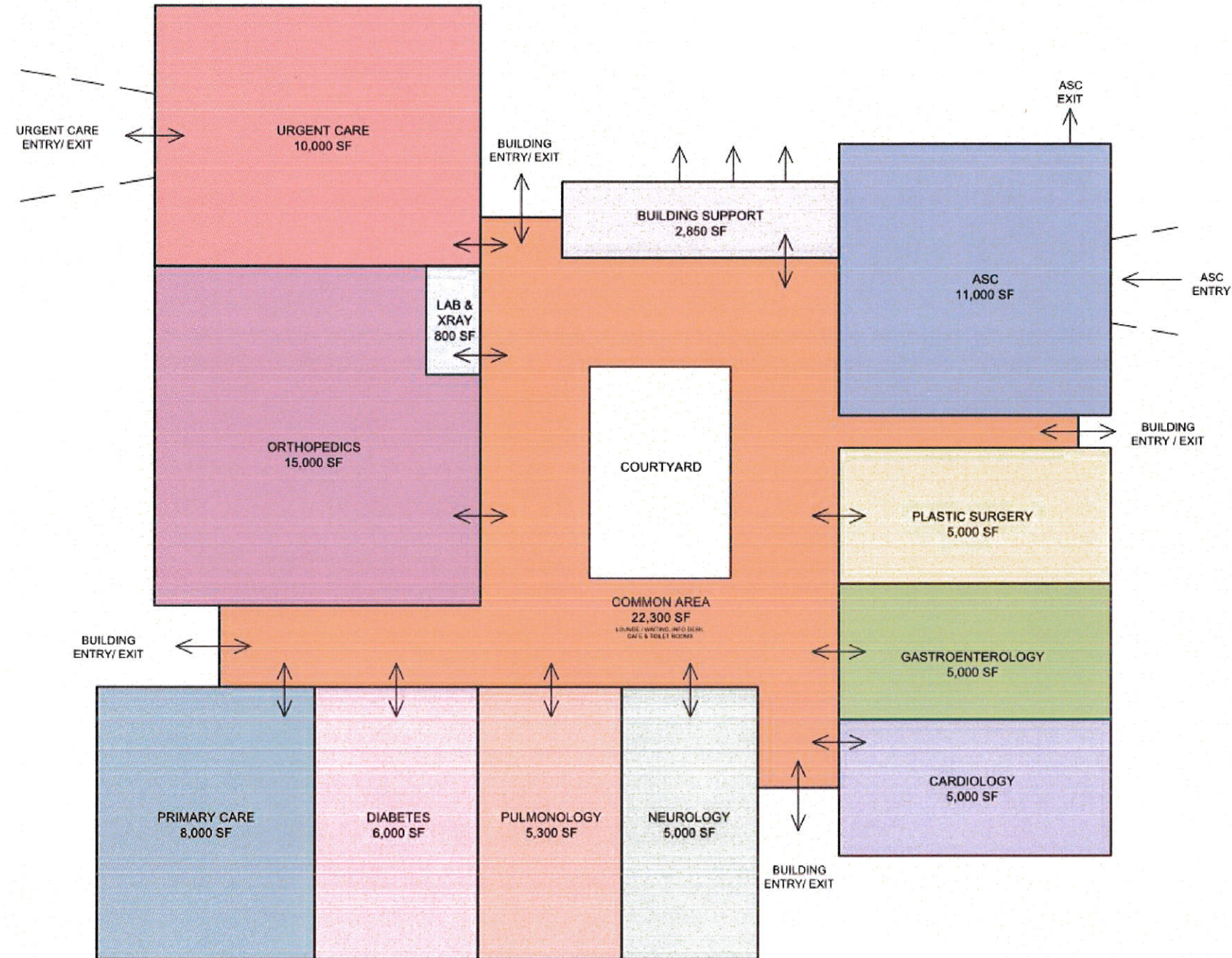
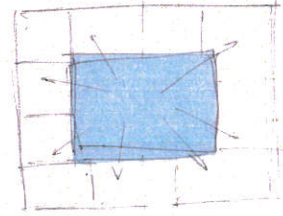

GROSS BUILDING AREA: 107,000 SF
535 PARKING SPACES @ 1 SPACE PER 200 SF



06-19-2017

CONCENTRIC

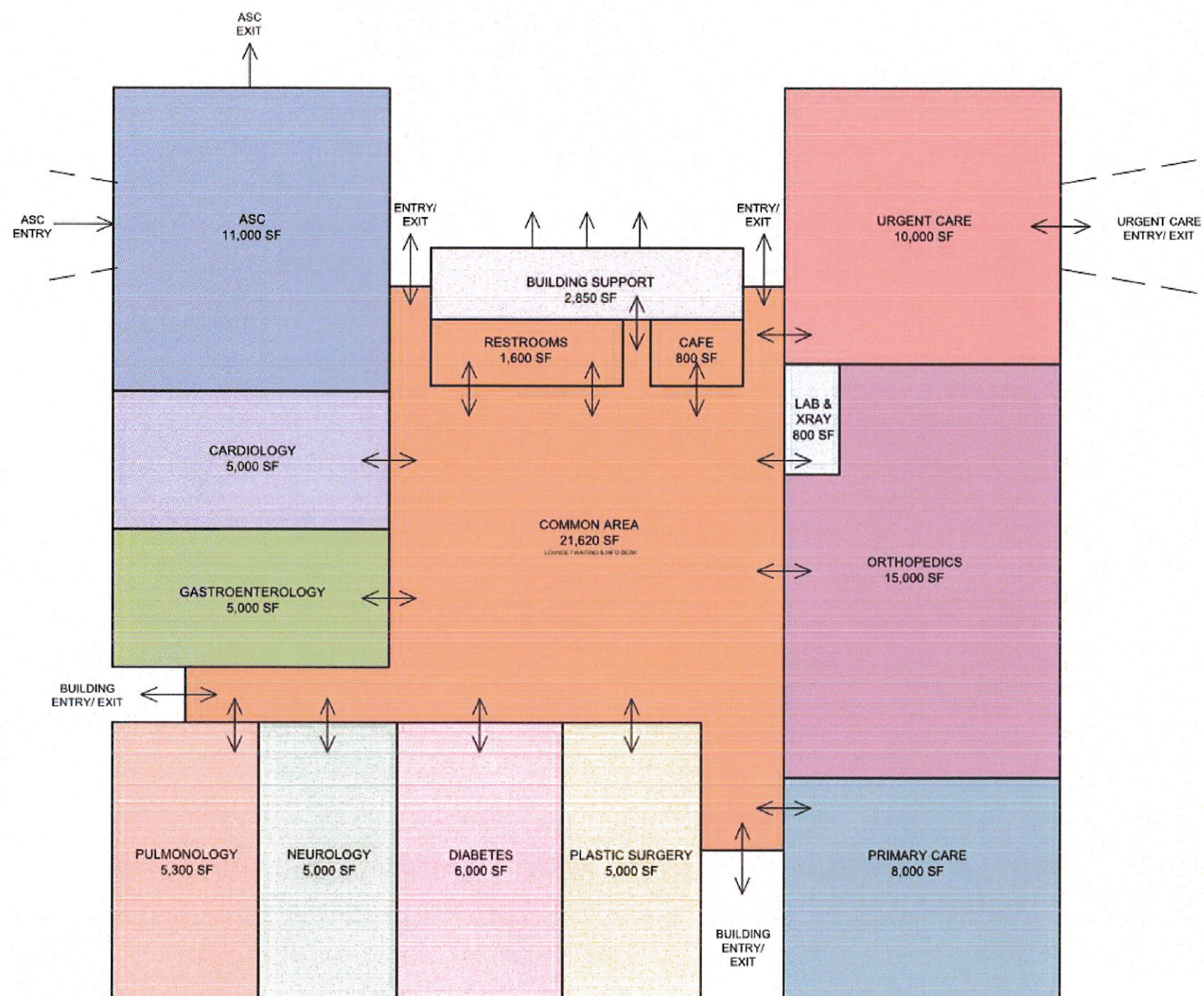
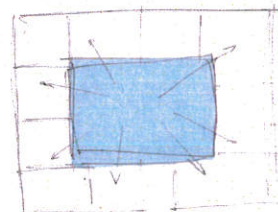

GROSS BUILDING AREA: 102,000 SF
510 PARKING SPACES @ 1 SPACE PER 200 SF



06-19-2017

Building Program - Diagram D

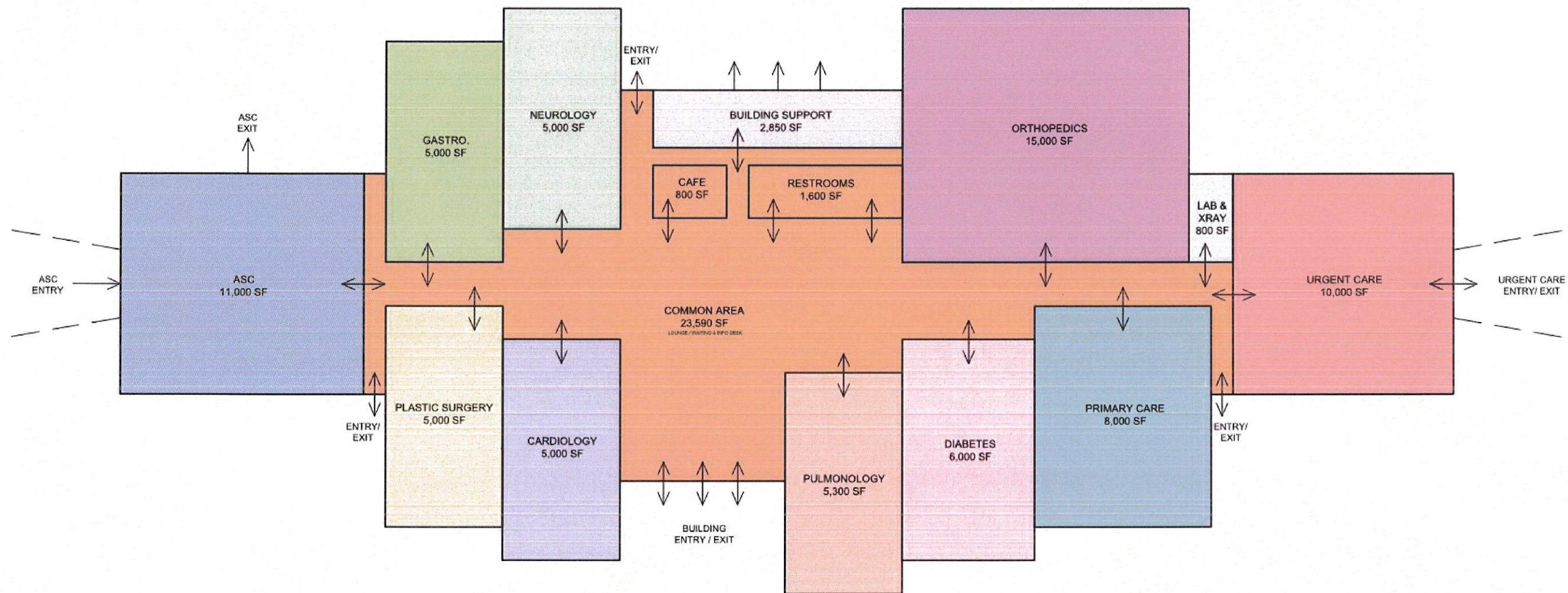
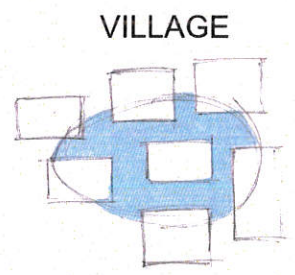

GROSS BUILDING AREA: 106,000 SF
530 PARKING SPACES @ 1 SPACE PER 200 SF



06-19-2017



06-19-2017

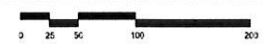

Site Plan

Atlantic General Hospital - Medical Office Building

WARE
HAUS